

What's Included

1. Mounting Bracket
2. Spacer Bushing, ID 9 x 27 mm
3. QR Thru-Axle, OD 9 x 159 mm
4. Towing Tube, 110 mm
5. Towing Tube, 70 mm
6. Towing Tube, 60 mm
7. Towing Tube, 34 mm
8. Towing Tube End, ID 9 mm
9. Towing Tube End, ID 12 mm
10. Towing Tube End, ID 15 mm
11. Disc Brake Pad Spacer
12. Fastening Strap x 2
13. M6 x 16 mm Screw x 2
14. M6 Washer x 4

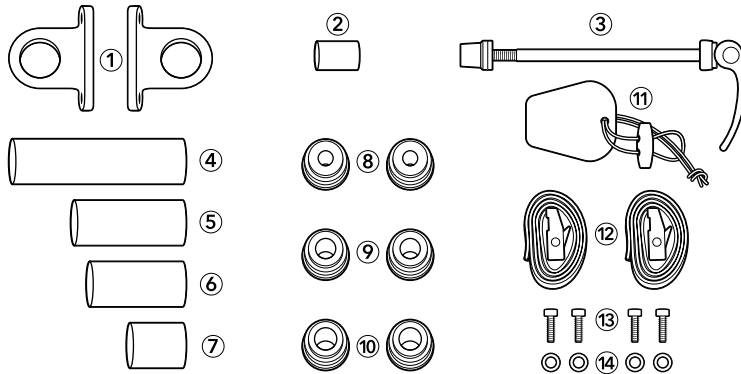

Weight Limits

- ⚠ For optimum handling, only tow bikes that weigh under 30 kg (66 lbs).

Safety

- ⚠ To provide extra visibility, turn on the rear light of the bike being towed.
- ⚠ Remove any accessories installed on the front of the bike being towed.

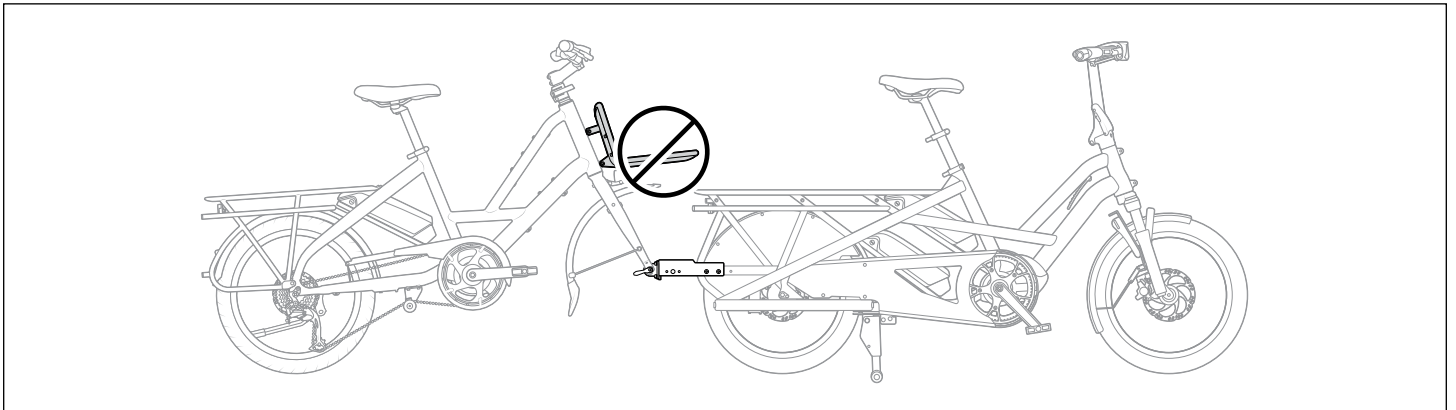

- ⚠ Practice riding with the towed bike in a safe location before riding on public roads.
- ⚠ Never allow passengers or pets on the towed bike.
- ⚠ Check to ensure that all accessories are correctly installed and securely fastened before riding.
- ⚠ To be able to back the GSD with a bike in tow, ensure that the detached front wheel is securely stored out of line of the towed bike's pedal rotation.

Preparation

1. The Tail Hitch L (sold separately) is required to install the Bike Tow Kit.



2. Identify the fork spacing of the bike being towed, and the Towing Tube you need.

Fork Spacing	Towing Tube Length	Image
150 mm	110 mm	 ④
110 mm	70 mm	 ⑤
100 mm	60 mm	 ⑥
74 mm	34 mm	 ⑦

3. Determine which Towing Tube Ends are required.

Insert the axle of the bike being towed into each of the Tube Ends and use the one that fits best.

4. Prepare the parts you need.

- Parts required for installation
 - Towing Tube x 1
 - Towing Tube Ends x 2
 - Mounting Brackets x 2
 - Fastening Straps x 2
 - M6 x 16 mm Screws x 4
 - M6 Washers x 4
- Parts used after installation
 - If the towed bike's fork spacing is 74 mm, prepare the Spacer Bushing 27 mm.
 - If the towed bike has disc brakes, prepare the Disc Brake Pad Spacer.
 - If the towed bike does not have a Thru-Axle, prepare the QR Thru-Axle.

How to Install

Tools Required (Not Included)

- 5 mm Allen Key

1. Install the Tail Hitch L (sold separately).

2. Install the Bike Tow Kit. Tighten bolts to a torque of 10 Nm - 11 Nm.

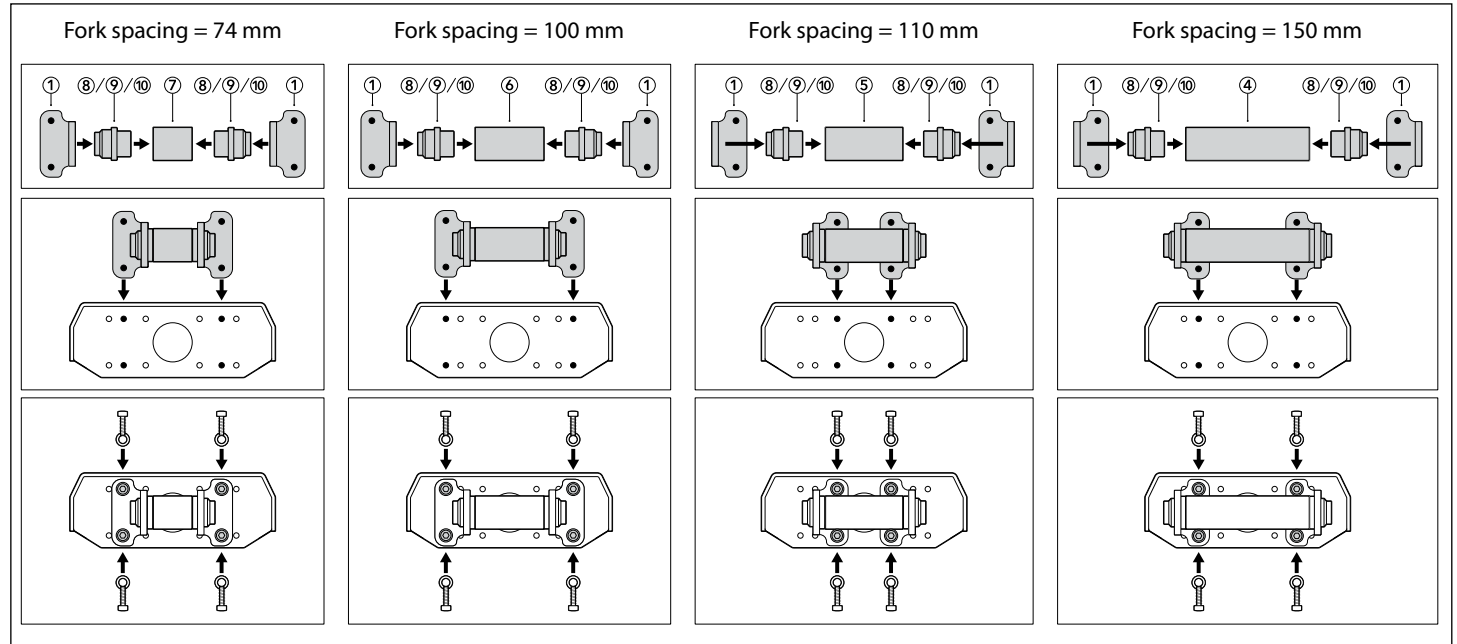

LIMITED PRODUCT WARRANTY INFORMATION: This Product comes with a ONE (1) YEAR Limited Warranty from the date of retail purchase by the original end-user. If a material or workmanship defect arises and a valid claim is received within the Warranty Period, this Product will be replaced. Mobility Holdings cannot be held liable for damages to personal property due to misuse or improper care and maintenance. This Product Warranty does not, under any circumstance, cover the replacement or cost of any third party product used with or connected to the Product.

Tern, the Tern Werd (logotype), and the Tern Berd (device) used alone or in combination are trade names, trade devices or registered trademarks of Mobility Holdings, Ltd.

© 2023. Tern is a trademark of Mobility Holdings, Ltd. All Rights Reserved.

@ternbicycles

ternbicycles.com

How to Use

1. Remove the front wheel.

2. Install the pad spacer if the bike has disc brakes.

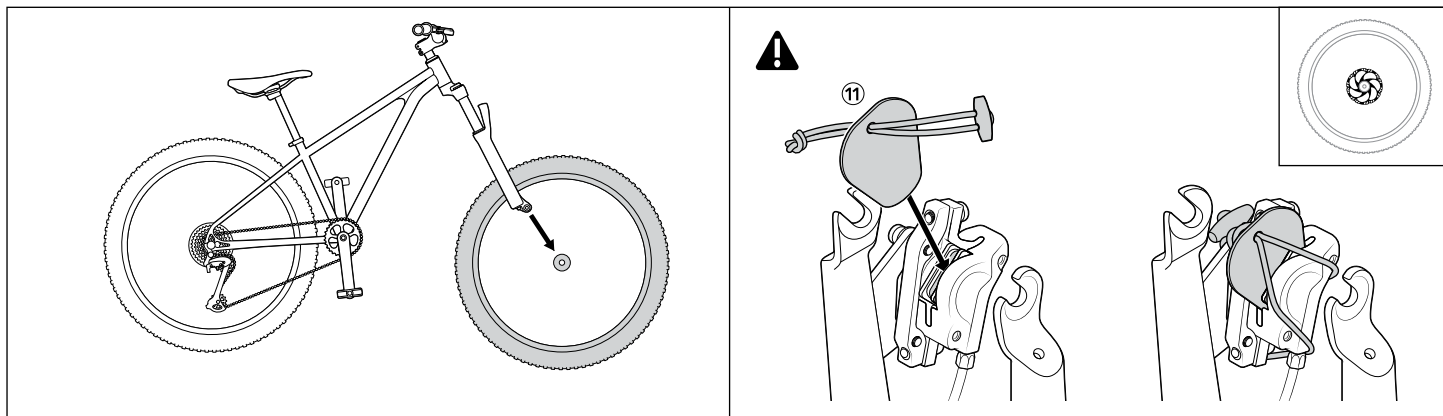

⚠ If the pad spacer is not installed, pulling on the front brake lever could result in the brake pads clamping together and getting stuck.

⚠ Avoid touching the brake rotor since oil or grease from your fingers can contaminate the surface.

3. Attach the fork to the Bike Tow Kit using the included QR Thru-Axle or your own Thru-Axle.

⚠ Insert the Spacer Bushing 27 mm if the towed bike's fork spacing is 74 mm.

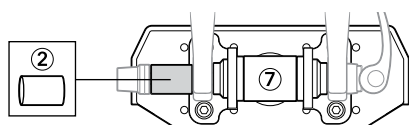

⚠ If using your own Thru-Axle, follow the instructions in your bike's user manual to securely tighten the bolts.

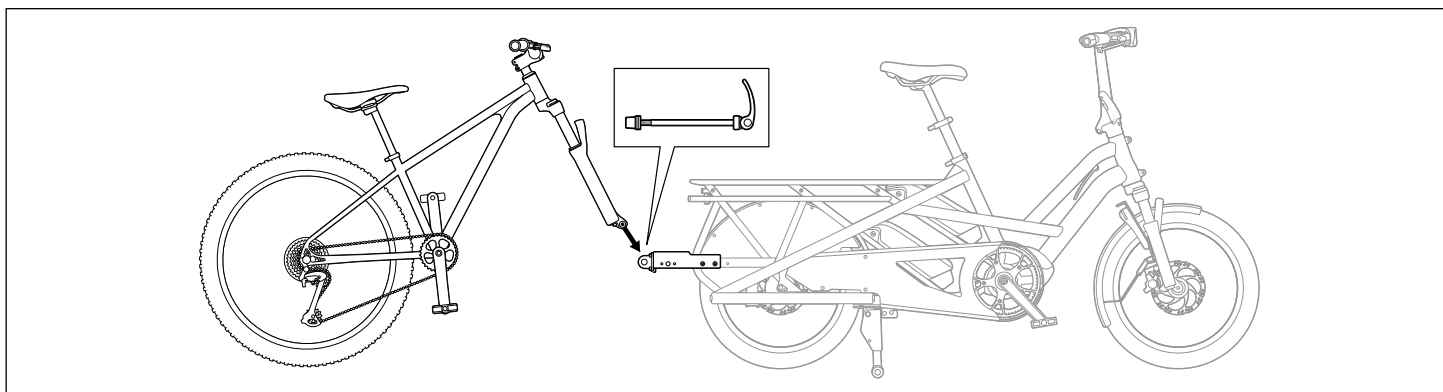

4. Secure the front wheel with the straps.

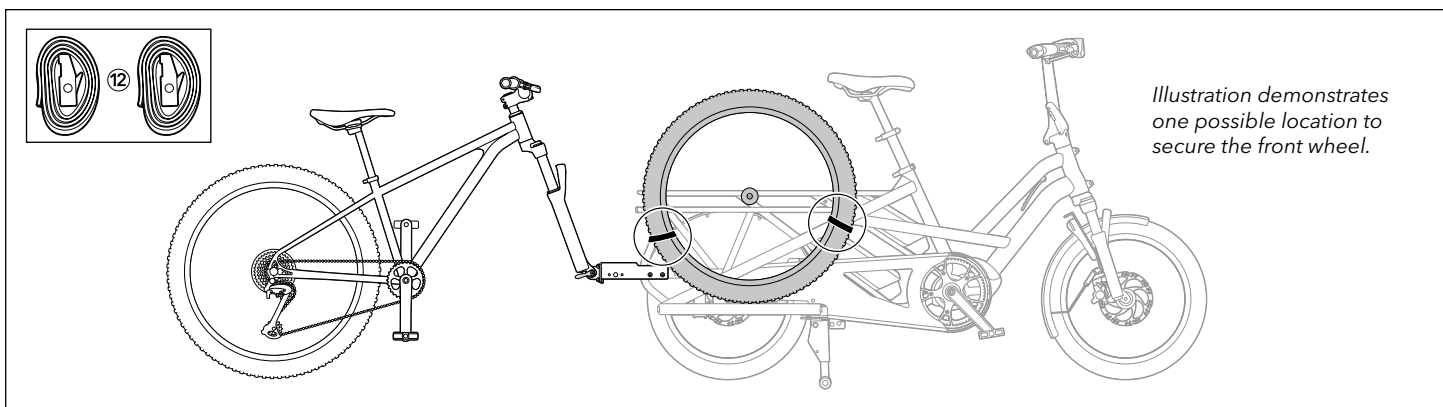

⚠ Before towing, ensure that the front wheel does not interfere with the pedals or steering of either bike.