

Manual Version 01

Make sure you have all the latest information needed to use and enjoy this product!

Visit ternbicycles.com/support for updated:



What's Included

- Market Basket

Max Load Capacity

- 10 kg (22 lb)

Safety

- ⚠ Check your bike's user manual and/or QuickStart Guide for information about maximum gross vehicle weight* and/or cargo weight** limits. Please do not exceed these weight limits.



* Maximum gross vehicle weight is the total weight of the bike, riders (the cyclist and any passengers), accessories, and cargo.

** Cargo weight is the total weight of passengers, accessories, and cargo.

- ⚠ Market Basket by itself is not intended for use as a pet carrier.
- ⚠ Check to ensure accessories have been correctly installed and securely fastened before riding.
- ⚠ Secure all cargo before riding. Make sure all straps are tied down and any loose item is secured.
- ⚠ Your bike may behave differently with cargo loaded.

Installation

- ⚠ Out of the box, Market Basket has been set up to mount on the rear racks of most Tern bikes. Visit ternbicycles.com/support to learn more.

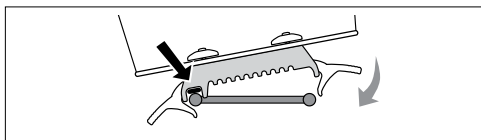

1. Rest the side of the mounting base marked by red indicators on the rack.

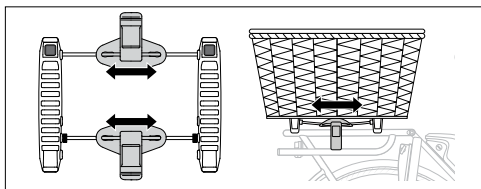

2. Set Market Basket down and check if the levers can close. If not, change the position of the levers anywhere along the spring rod and test again.

- ⚠ Ensure there are no objects, such as strap holder, that are preventing the levers from closing completely.

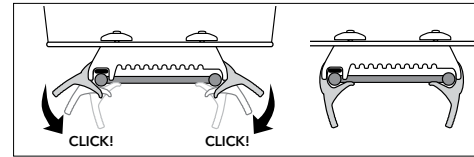

3. Close the levers by pushing them inwards until tight and you hear a "Click" sound.

- ⚠ Ensure Market Basket is securely mounted before riding.

How to Change Mounting Orientation

Tools Required (Not Included): Phillips Screwdriver

- ⚠ By default, Market Basket has been set up to mount in parallel with your bike, which allows easy access to your panniers. Follow the instructions below only if you wish to switch to a perpendicular mounting orientation.

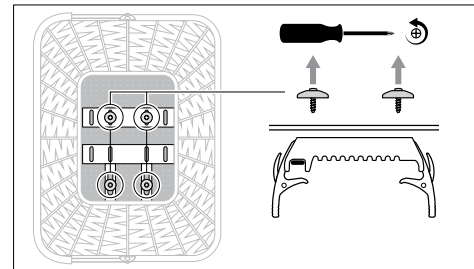

1. Loosen bracket screws with Phillips Screwdriver.

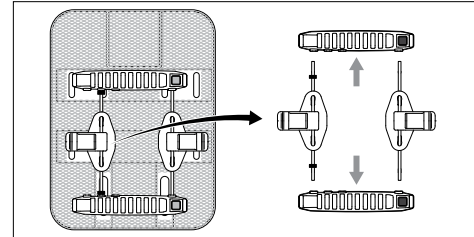

2. Remove spring rods, levers, and brackets.

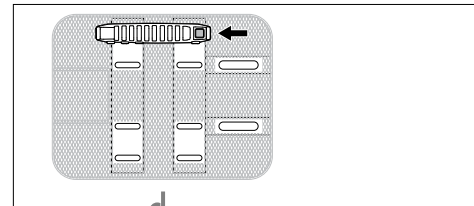

3. Adjust bracket location.

- With Market Basket in lengthwise position (as shown), align one bracket with the two uppermost mounting slots, ensuring the red indicator is on the right hand side.
- Shift said bracket leftwards until both screw holes reach the leftmost side of their respective mounting slot. This is to ensure Market Basket is centered when mounted onto Tern rear racks that are 14.4 cm wide and use 16 mm round tube*.

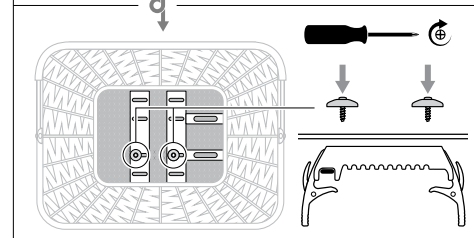

- * For other rear racks, the bracket may need to be shifted rightwards so both screw holes are positioned towards the center or right of the mounting slots to ensure Market Basket is centered when mounted.

4. Place the washers, insert the screws and tighten screws to a maximum torque of 2 Nm.

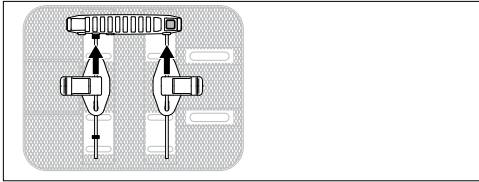

5. Reinsert spring rods and levers into the bracket.

⚠ The spring rod away from the red indicator is placed in the middle slot by default. Read **How to Adjust for Different Racks** for more information.

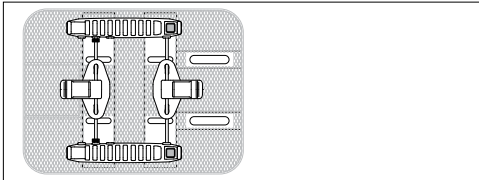

6. Repeat steps 3-4 to install the other bracket.

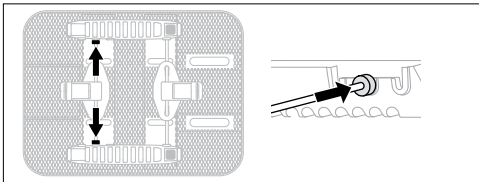

7. Slide the rubber retainer rings against the brackets.

How to Adjust for Different Racks

⚠ Market Basket is factory preset to mount on Tern rear racks that are 14.4 cm wide and use 16 mm round tube.

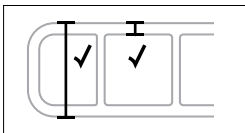

Market Basket's KLICKfix® TopKlip mounting system adjusts to fit bicycle rear racks between 9 - 16 cm wide and have a round tube diameter between 10 - 16 mm, so it's possible to mount on different racks.

To Adjust for Rack Width:

Below is our recommended settings for various rack widths. Depending on your rack manufacturer, you may need to experiment to determine which setting works best.

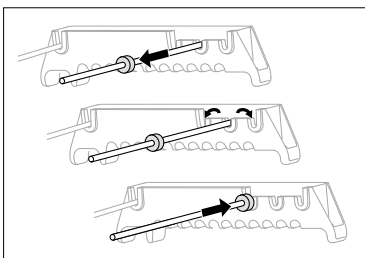
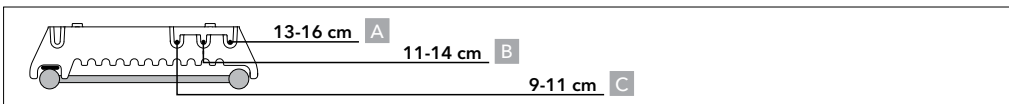

1. Slide the rubber retainer rings on the spring rod away from the bracket.
2. Push both ends of the spring rod away from the notch and shift rod to the desired position. Please check the above diagram to see which setting (A, B, or C) is most appropriate for your rack width.
3. Slide the rubber retainer rings towards the bracket.

To Adjust for Rack Tube Diameter:

Tools Required (Not Included): Phillips Screwdriver

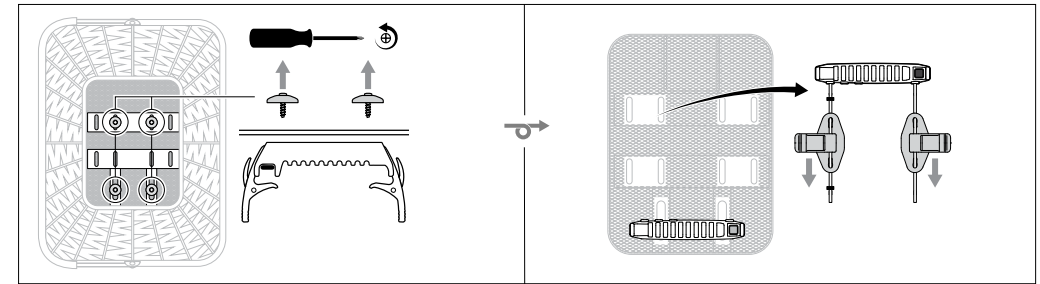

1. Detach one bracket and remove both spring rods.

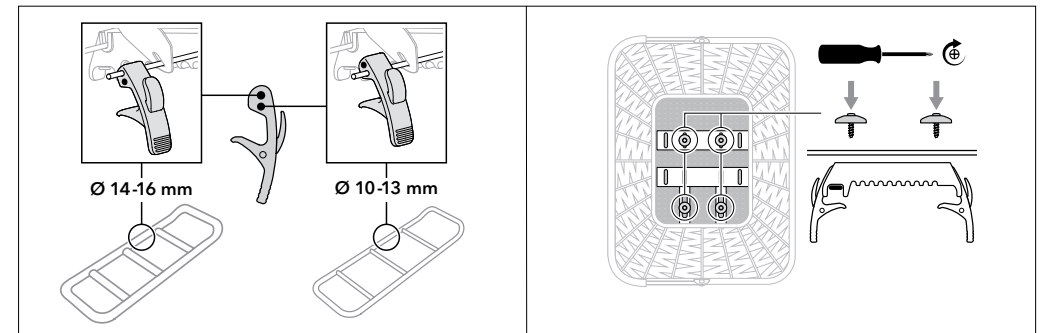

2. Locate the appropriate hole for your rack tube diameter on the levers, and reinsert spring rods into the bracket.

3. Tighten screws to a maximum torque of 2 Nm.

LIMITED PRODUCT WARRANTY INFORMATION: This Product comes with a ONE (1) YEAR Limited Warranty from the date of retail purchase by the original end-user. If a material or workmanship defect arises and a valid claim is received within the Warranty Period, this Product will be replaced. Mobility Holdings cannot be held liable for damages to personal property due to misuse or improper care and maintenance. This Product Warranty does not, under any circumstance, cover the replacement or cost of any third party product used with or connected to the Product.

Tern, the Tern Werd (logotype), the Tern Berd (device), and Market Basket used alone or in combination are trade names, trade devices, or registered trademarks of Mobility Holdings, Ltd.

Trademarks are the property of their respective owners.

© 2024. Tern is a trademark of Mobility Holdings, Ltd. All Rights Reserved.

@ternbicycles

ternbicycles.com