

## Manual Version 01

Make sure you have all the latest information needed to use and enjoy this product!

Visit [ternbicycles.com/support](https://ternbicycles.com/support) for updated:



MANUALS



COMPATIBILITY



ARTICLES



VIDEOS



& MORE



## What's Included

- MudShield mud flap x 1
- Securing Rivet x 2
- Retainer x 2

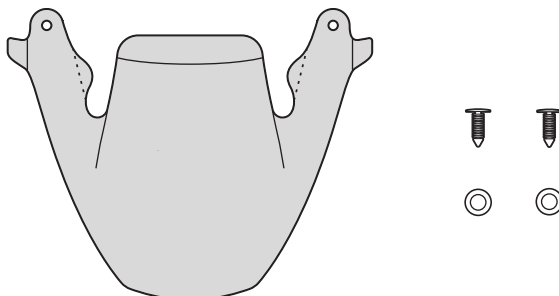

## Installation

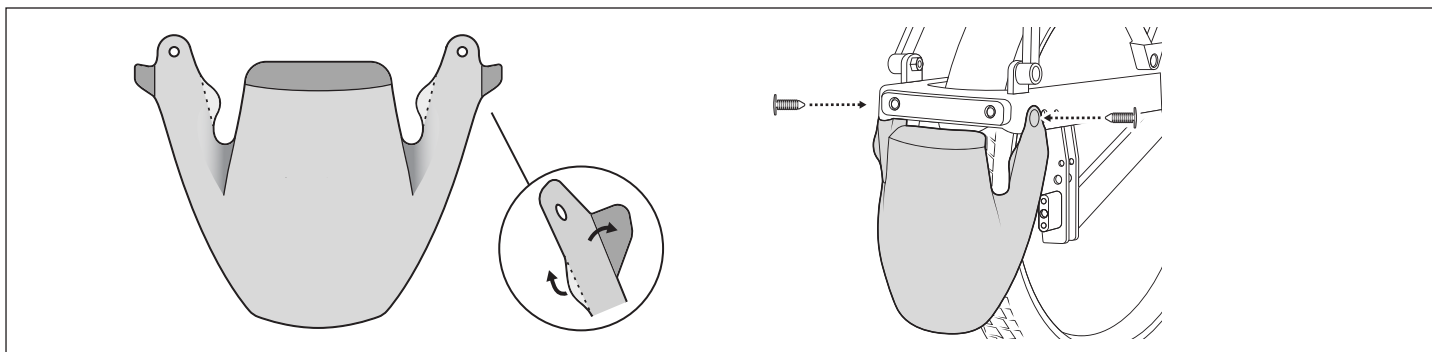

1. With the front side of the mud flap facing you, fold dotted-lined sections upward, and all remaining sections along their respective lines downward (see illustration).
2. Align the two top holes with the rearmost pair of trailer mounting holes and insert the included rivets. Firmly press rivets until MudShield is secured to the bike.

**⚠ Retainer may be required to complete Installation. In rare cases, it may be necessary to insert a Retainer (included) on the opposite side of each Rivet to secure MudShield to bike.**

## Vertical Parking & Rolling

Depending on your bike model, MudShield may be flipped up to support vertical parking & rolling.

**LIMITED PRODUCT WARRANTY INFORMATION:** This Product comes with a ONE (1) YEAR Limited Warranty from the date of retail purchase by the original end-user. If a material or workmanship defect arises and a valid claim is received within the Warranty Period, this Product will be replaced. Mobility Holdings cannot be held liable for damages to personal property due to misuse or improper care and maintenance. This Product Warranty does not, under any circumstance, cover the replacement or cost of any third party product used with or connected to the Product.

Tern, the Tern Werd (logotype), the Tern Berd (device), and MudShield, used alone or in combination are trade names, trade devices, or registered trademarks of Mobility Holdings, Ltd.

© 2025. Tern is a trademark of Mobility Holdings, Ltd. All Rights Reserved.

@ternbicycles

[ternbicycles.com](https://ternbicycles.com)