

## Required Equipment

⚠ Transporteur Rack is required for installing the Cargo Box 34. To install, follow the rack's manual or download the manual at [ternbicycles.com/support](http://ternbicycles.com/support).

## Weight Limits

⚠ Do not exceed the load limit of 17 kg (37 lb).

## What's Included

- Cargo Box 34
- M5 x 30 mm Bolt x 4
- M5 x OD 16 x T1 mm Washer x 4
- M5 x OD 12 x T1 mm Washer x 4
- M5 Nylon Nut x 4

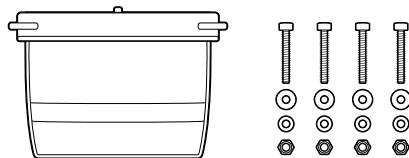

## Tools Required (Not Included)

- 3 mm and 4 mm Allen Wrench
- 8 mm Open-End Wrench



## Installation

⚠ Add anti-seize lubricant to the tip of the bolts before securing the nuts. If anti-seize lubricant is not available, apply any standard lubricant to reduce friction and prevent thread galling.

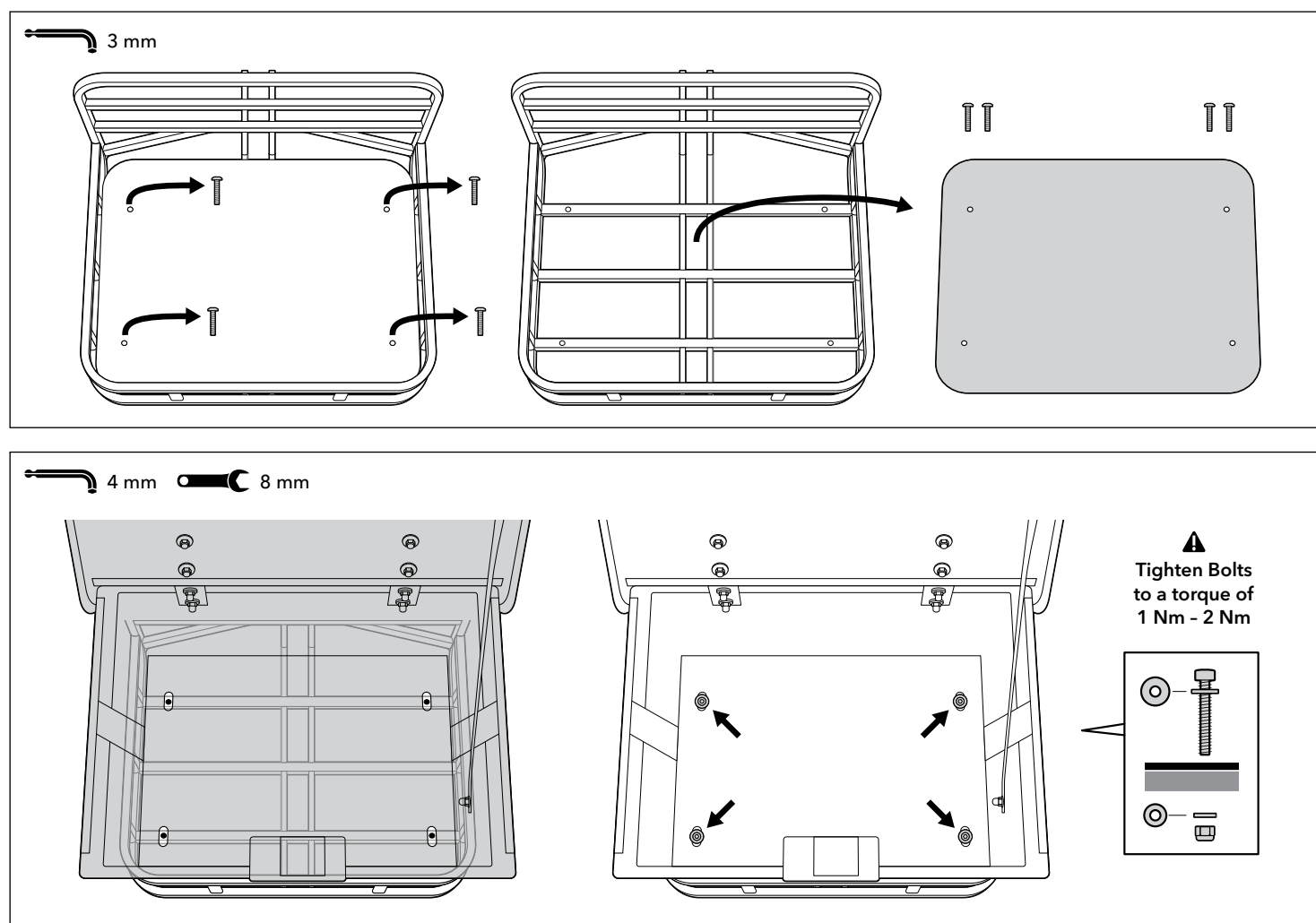

**LIMITED PRODUCT WARRANTY INFORMATION:** This Product comes with a ONE (1) YEAR Limited Warranty from the date of retail purchase by the original end-user. If a material or workmanship defect arises and a valid claim is received within the Warranty Period, this Product will be replaced. Mobility Holdings cannot be held liable for damages to personal property due to misuse or improper care and maintenance. This Product Warranty does not, under any circumstance, cover the replacement or cost of any third party product used with or connected to the Product.

The word Tern, stylized word Tern, and Tern logo are registered and unregistered trademarks of Mobility Holdings, Ltd., its affiliates or its respective owners in many jurisdictions worldwide.

©2023. Mobility Holdings, Ltd.

[bikesforbusiness.com](http://bikesforbusiness.com)